

Inductive Transducer

Differential Inductor Type

Special design **WLH ... RS** 120°C

MESSOTRON

radial connector interface

mating connector provided
core channel continuous

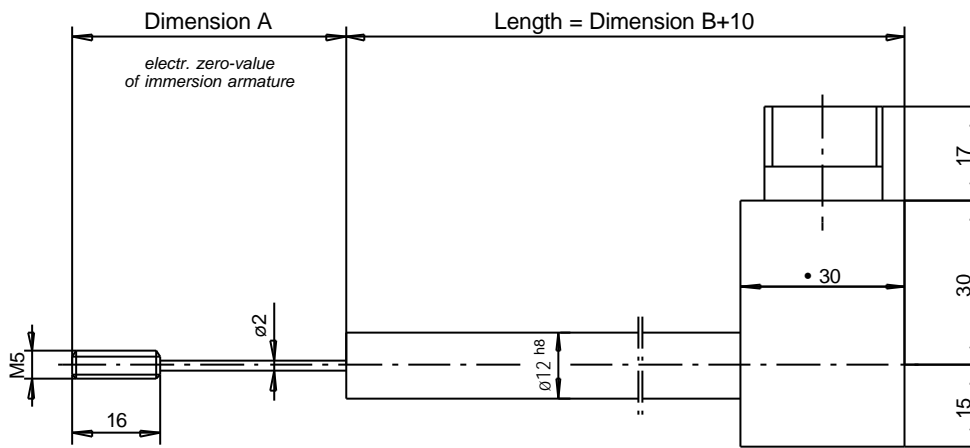
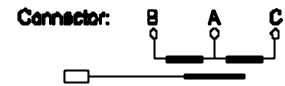

Example: WLH 50 RS 0.5%

		WLH 10	WLH 20	WLH 50	WLH 100	WLH 150	WLH 200	WLH 250	WLH 300	WLH 400	WLH 500
Nominal stroke	mm	±5	±10	±25	±50	±75	±100	±125	±150	±200	±250
Maximum stroke	mm	20	30	60	120	170	220	270	320	420	520
Dimension A	mm	40	40	50	100	130	150	180	200	250	300
Dimension B	mm	80	100	145	245	355	455	565	675	875	1065
Transducer weight	g	40	60	85	120	150	200	230	280	350	440
Plunger weight	g	6	8	9	12	15	20	25	30	40	50
Nominal output signal	mV/V	90	140	250	300	310	320	340	340	310	340
Sensitivity	mV/V/mm	18	14	10	6	4	3,2	2,7	2,2	1,5	1,4
Excitation voltage	V eff	up to 5									
Excitation frequency	kHz	5 ... 10									
Linearity *)		±0.5%F.S.O. options: 0.25% und 0.1%									
Temperature error of zero		±0.02% / 10K									
Temperature error of span		±0.05% / 10K									
Operating temperature		-50°C ... +120°C									
Protection class (DIN 40050)		IP 64									

*) select option when ordering

MESSOTRON
Hennig GmbH & Co. KG
Industrie-Messtechnik
Friedr.-Evert-Str. 37, Tel.: (06257) 82331
D-64342 Seeheim-Jugenheim

WLH ... RS Series
10 ... 500 mm

Drawing
16.48.01

Date 07/96
Previous issue: 16.48.00

Design of transducers can be customised

subject to change without prior notice